

5SDD 40H4000

Old part no. DV 889-4000-40

Rectifier Diode

Properties

- ③ Industry standard housing
- ③ Suitable for parallel operation
- ③ High operating temperature
- ③ Low forward voltage drop

Key Parameters

V_{RRM}	= 4 000 V
I_{FAVm}	= 3 847 A
I_{FSM}	= 46 000 A
V_{TO}	= 0.900 V
r_T	= 0.133 m:

Types

	V_{RRM}
5SDD 40H4000	4 000 V
Conditions:	$T_j = -40 \div 160 \text{ }^\circ\text{C}$, half sine waveform, $f = 50 \text{ Hz}$

F_m	Mounting force	50 ± 5 kN
m	Weight	0.9 kg
D_s	Surface creepage distance	40 mm
D_a	Air str ke distance	20 mm

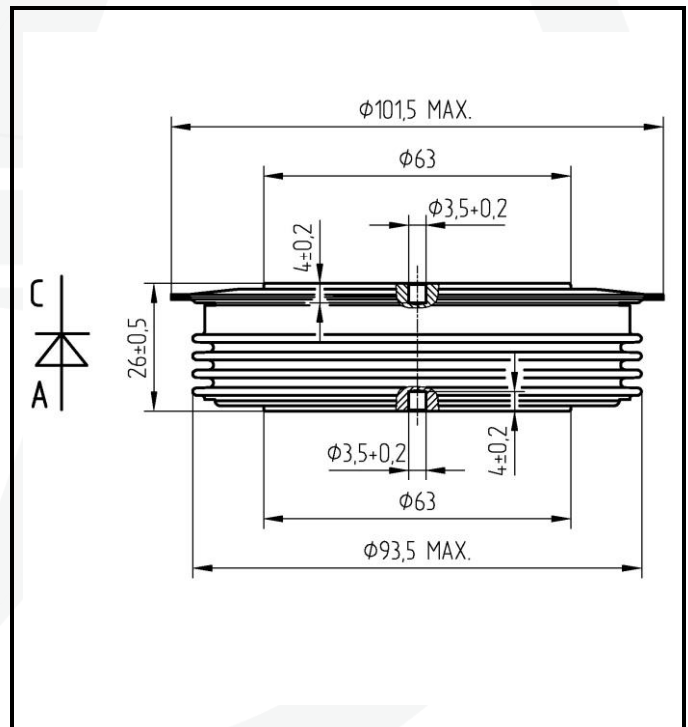

Mechanical Data

Maximum Ratings		Maximum Limits	Unit	
V_{RRM}	Repetitive peak reverse voltage $T_j = -40 \div 160 \text{ }^\circ\text{C}$	4 000	V	
I_{FAVm}	Average forward current $T_c = 85 \text{ }^\circ\text{C}$	3 847	A	
I_{FRMS}	RMS forward current $T_c = 85 \text{ }^\circ\text{C}$	6 043	A	
I_{RRM}	Repetitive reverse current $V_R = V_{RRM}$	100	mA	
I_{FSM}	Non repetitive peak surge current $V_R = 0 \text{ V}$, half sine pulse	$t_p = 8.3 \text{ ms}$	49 000	A
		$t_p = 10 \text{ ms}$	46 000	A
I^2t	Limiting load integral $V_R = 0 \text{ V}$, half sine pulse	$t_p = 8.3 \text{ ms}$	10 020 000	A ² s
		$t_p = 10 \text{ ms}$	10 580 000	A ² s
$T_{jmin} - T_{jmax}$	Operating temperature range	-40 \div 160	$^\circ\text{C}$	
T_{STG}	Storage temperature range	-40 \div 160	$^\circ\text{C}$	

Unless otherwise specified $T_j = 160 \text{ }^\circ\text{C}$

Characteristics	Value			Unit	
	min	typ	max		
$V_{TO} r_T$	Threshold voltage			0.900	V
	Forward slope resistance $I_{F1} = 6\,283 \text{ A}$, $I_{F2} = 18\,850 \text{ A}$			0.133	m:
V_{FM}	Maximum forward voltage $I_{FM} = 4\,000 \text{ A}$			1.41	V
Q_{rr}	Recovered charge $V_R = 100 \text{ V}$, $I_{FM} = 2000 \text{ A}$, $di_F/dt = -30 \text{ A}/\mu\text{s}$			4 600	μC

Unless otherwise specified $T_j = 160 \text{ }^\circ\text{C}$

Thermal Parameters			Value	Unit
R_{thjc}	Thermal resistance junction to case	double side cooling	8.0	K/kW
		anode side cooling	14.5	
		cathode side cooling	18.0	
R_{thch}	Thermal resistance case to heatsink	double side cooling	2.5	K/kW
		single side cooling	5.0	

Transient Thermal Impedance

Analytical function for transient thermal impedance

$$Z_{thjc} = \sum_{i=1}^4 R_i (1 - \exp(-t / W_i))$$

Conditions:
 $F_m = 50 \pm 5$ kN, Double side cooled

Correction for periodic waveforms

180° sine:	1.0 K/kW
120° sine:	1.5 K/kW
60° sine:	2.5 K/kW
180° rectangular:	0.9 K/kW
120° rectangular:	1.5 K/kW
60° rectangular:	2.5 K/kW

i	1	2	3	4
W_i (s)	0.4406	0.1045	0.0092	0.0022
R_i (K/kW)	4.533	2.255	0.868	0.345

Fig. 2 Dependence transient thermal impedance junction to case on square pulse

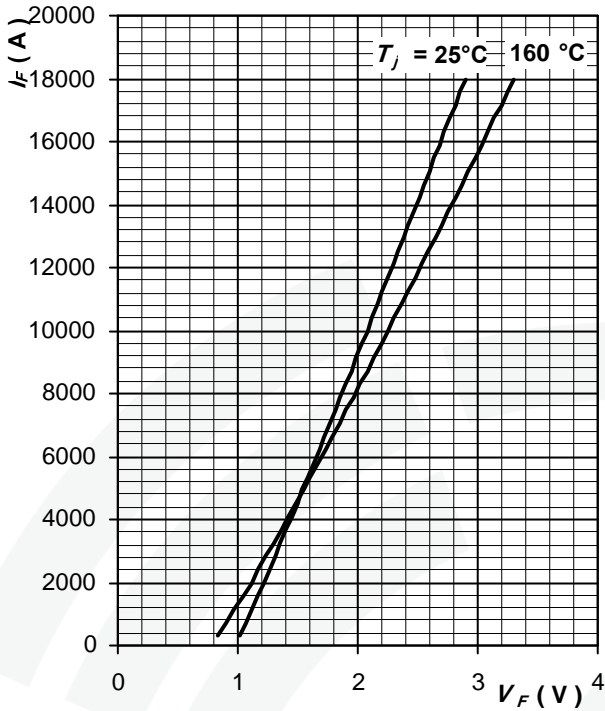

Fig. 3 Maximum forward voltage drop characteristics

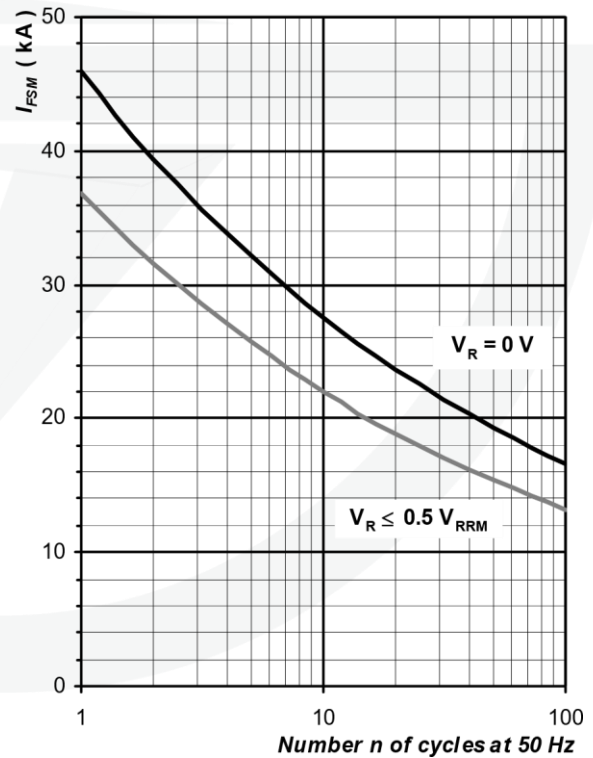
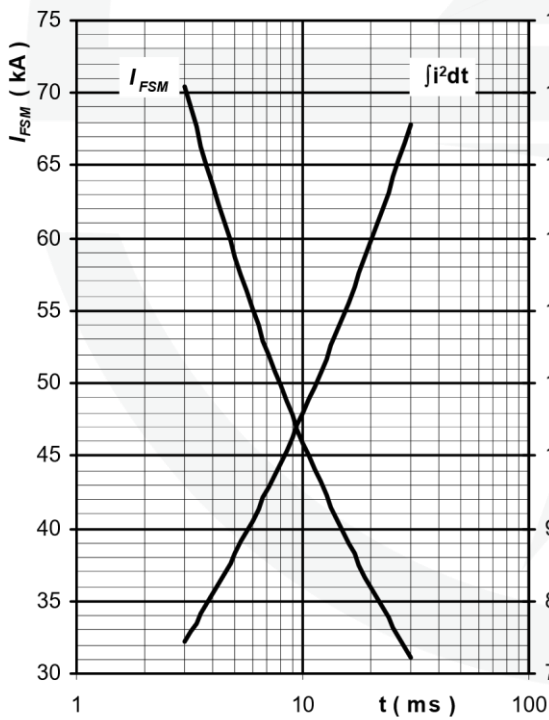

Fig. 4 Surge forward current vs. pulse length, Fig. 5 Surge forward current vs. number half sine wave, single pulse, of pulses, half sine wave, $T_j = T_{jmax}$
 $V_R = 0 V, T_j = T_{jmax}$

Fig. 6 Forward power loss vs. average forward current, sine waveform, $f = 50 \text{ Hz}$, $T = 1/f$

Fig. 7 Forward power loss vs. average forward current, square waveform, $f = 50 \text{ Hz}$, $T = 1/f$

Fig. 8 Max. case temperature vs. aver. forward current, sine waveform, $f = 50 \text{ Hz}$, $T = 1/f$

Fig. 9 Max. case temperature vs. aver. forward current, square waveform, $f = 50 \text{ Hz}$, $T = 1/f$

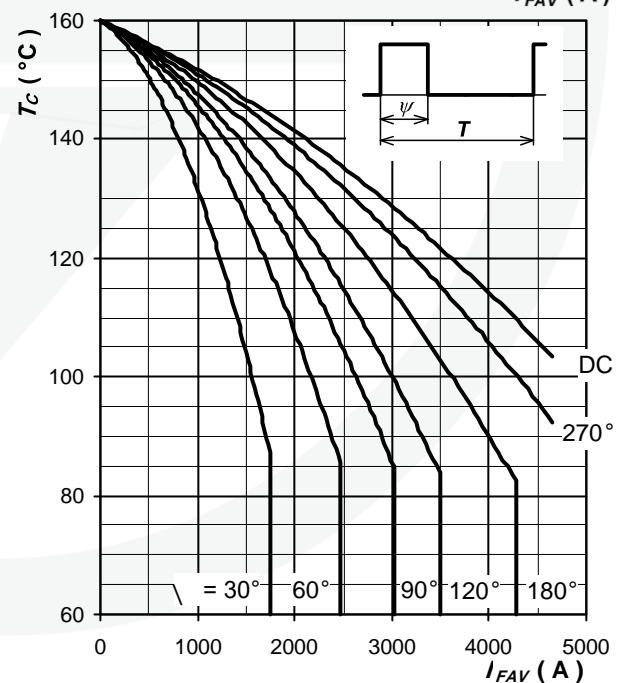
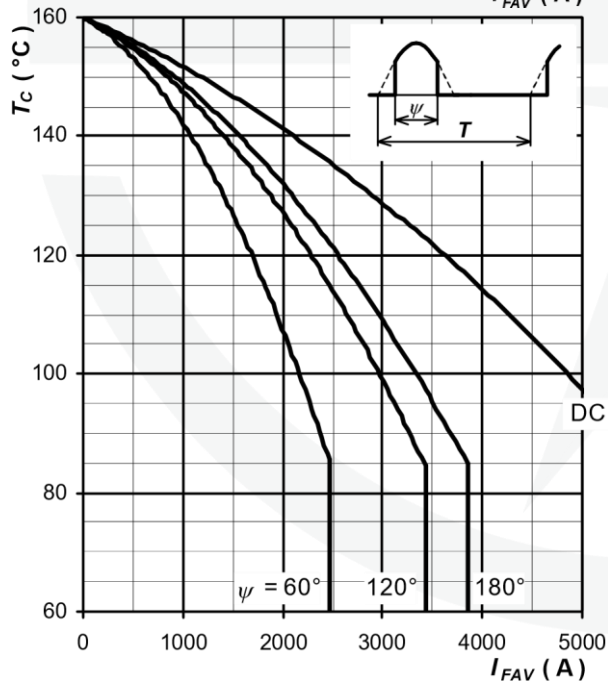
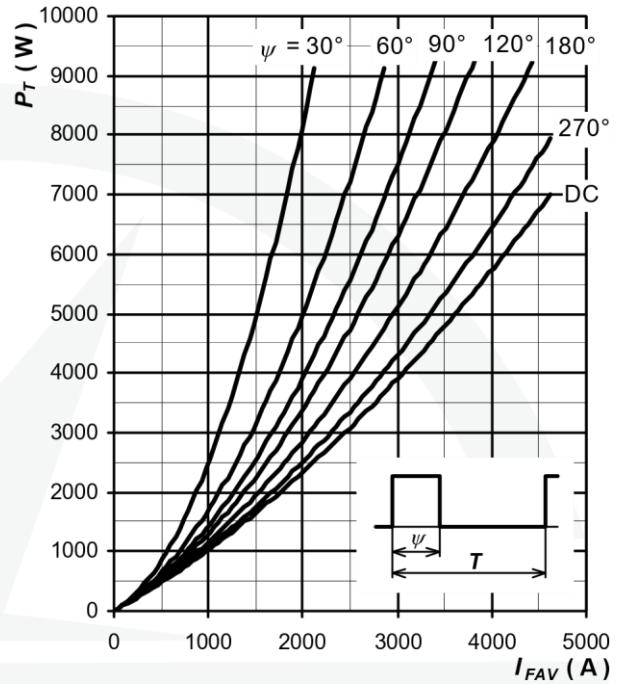
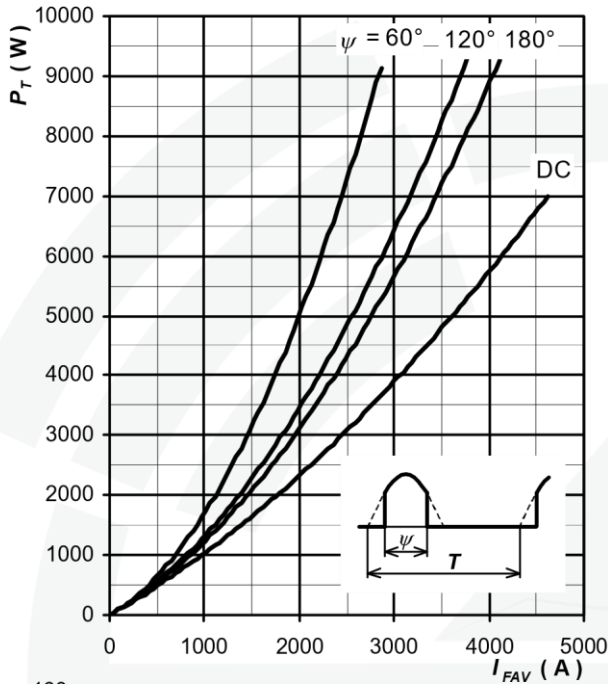

Notes:

